

**異面工作，裏面共作，scenario**

**이면공작，이면공작，시나리오**

자기자신의 사회적 이름으로

저소득 국가의

경제적 주변부

디자이너의

시간 밀도 높이기 ( 시간의 의미는 용법이다.)

공간 밀도 높이기 ( 공간의 의미는 용법이다.)

이면공작 시나리오는

작업실을 가지고 있는

( 주거 및 생활공간 포함 - 지하, 옥탑, 자취방 )

작가들의

( 작가 1 - 프리랜서 : 사회구저상 앞으로 늘어날 수 밖에 없을 비정규직 노동자)

( 작가 2 - 전업작가 : 여러가지 이유 ( 정체성 고민 포함)로 인한 구직 단념자, 실업자)

외부와의 소통 문제를

( 살아남기 )

고민하는 프로젝트 입니다

공간 TYPE 1

(i) SM- Type S

(⊕) SM- Type ML

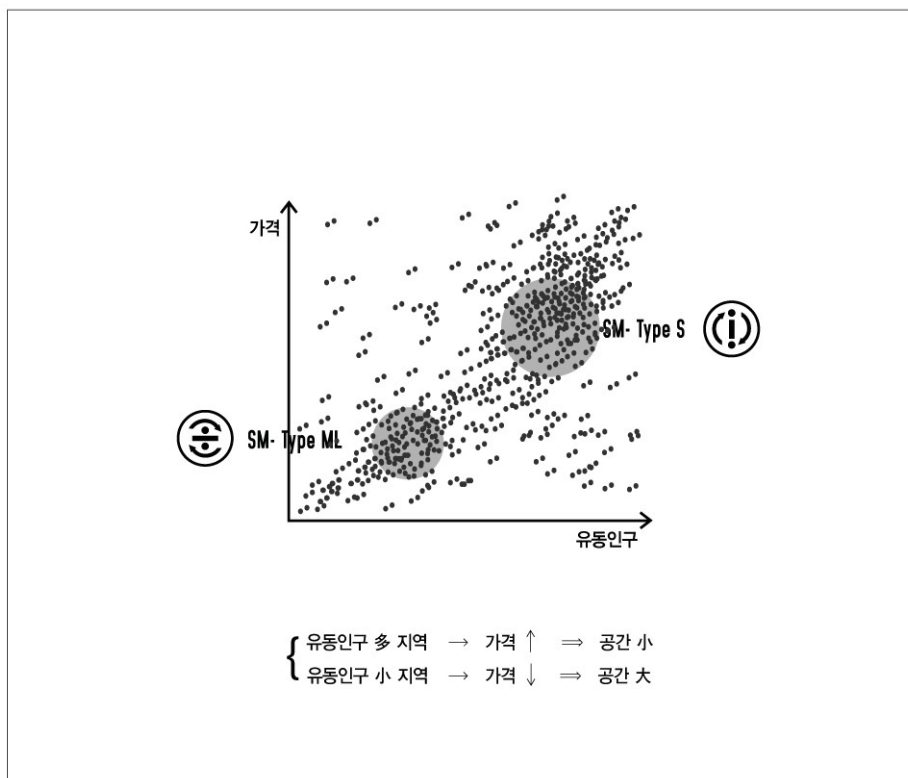

	(i) SM- Type S	(⊕) SM- Type ML
floor space	8 ~ 10 py	30 ~ 40 py
price	50 ~ 70 만원	60 ~ 90 만원
the number of persons	5 ~ 6 명	7 ~ 9 명
per persons / price	10 만원 선	10 ~ 15만원 선
notice	- 작은 작업을 하는 다기능 소통공간 - 유동인구가 많은 지역	- 큰 규모의 작업 - 개인당 확보된 넓은 공간 필수 ( 위치 < 공간확보 )

START  
 ↓  
 furniture to be moved

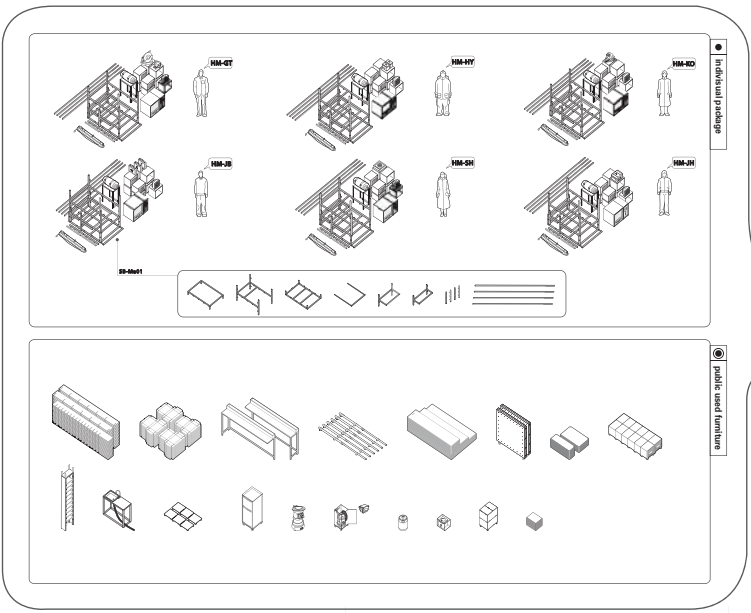

HM-0000	Individual Package	Public use furniture
HM-01	SS-0001	SS-0001
HM-02	SS-0002	SS-0002
HM-03	SS-0003	SS-0003
HM-04	SS-0004	SS-0004
HM-05	SS-0005	SS-0005
HM-06	SS-0006	SS-0006
HM-07	SS-0007	SS-0007
HM-08	SS-0008	SS-0008
HM-09	SS-0009	SS-0009
HM-10	SS-0010	SS-0010
HM-11	SS-0011	SS-0011
HM-12	SS-0012	SS-0012
HM-13	SS-0013	SS-0013
HM-14	SS-0014	SS-0014
HM-15	SS-0015	SS-0015
HM-16	SS-0016	SS-0016
HM-17	SS-0017	SS-0017
HM-18	SS-0018	SS-0018
HM-19	SS-0019	SS-0019
HM-20	SS-0020	SS-0020
HM-21	SS-0021	SS-0021
HM-22	SS-0022	SS-0022
HM-23	SS-0023	SS-0023
HM-24	SS-0024	SS-0024
HM-25	SS-0025	SS-0025
HM-26	SS-0026	SS-0026
HM-27	SS-0027	SS-0027
HM-28	SS-0028	SS-0028
HM-29	SS-0029	SS-0029
HM-30	SS-0030	SS-0030
HM-31	SS-0031	SS-0031
HM-32	SS-0032	SS-0032
HM-33	SS-0033	SS-0033
HM-34	SS-0034	SS-0034
HM-35	SS-0035	SS-0035
HM-36	SS-0036	SS-0036
HM-37	SS-0037	SS-0037
HM-38	SS-0038	SS-0038
HM-39	SS-0039	SS-0039
HM-40	SS-0040	SS-0040
HM-41	SS-0041	SS-0041
HM-42	SS-0042	SS-0042
HM-43	SS-0043	SS-0043
HM-44	SS-0044	SS-0044
HM-45	SS-0045	SS-0045
HM-46	SS-0046	SS-0046
HM-47	SS-0047	SS-0047
HM-48	SS-0048	SS-0048
HM-49	SS-0049	SS-0049
HM-50	SS-0050	SS-0050
HM-51	SS-0051	SS-0051
HM-52	SS-0052	SS-0052
HM-53	SS-0053	SS-0053
HM-54	SS-0054	SS-0054
HM-55	SS-0055	SS-0055
HM-56	SS-0056	SS-0056
HM-57	SS-0057	SS-0057
HM-58	SS-0058	SS-0058
HM-59	SS-0059	SS-0059
HM-60	SS-0060	SS-0060
HM-61	SS-0061	SS-0061
HM-62	SS-0062	SS-0062
HM-63	SS-0063	SS-0063
HM-64	SS-0064	SS-0064
HM-65	SS-0065	SS-0065
HM-66	SS-0066	SS-0066
HM-67	SS-0067	SS-0067
HM-68	SS-0068	SS-0068
HM-69	SS-0069	SS-0069
HM-70	SS-0070	SS-0070
HM-71	SS-0071	SS-0071
HM-72	SS-0072	SS-0072
HM-73	SS-0073	SS-0073
HM-74	SS-0074	SS-0074
HM-75	SS-0075	SS-0075
HM-76	SS-0076	SS-0076
HM-77	SS-0077	SS-0077
HM-78	SS-0078	SS-0078
HM-79	SS-0079	SS-0079
HM-80	SS-0080	SS-0080
HM-81	SS-0081	SS-0081
HM-82	SS-0082	SS-0082
HM-83	SS-0083	SS-0083
HM-84	SS-0084	SS-0084
HM-85	SS-0085	SS-0085
HM-86	SS-0086	SS-0086
HM-87	SS-0087	SS-0087
HM-88	SS-0088	SS-0088
HM-89	SS-0089	SS-0089
HM-90	SS-0090	SS-0090
HM-91	SS-0091	SS-0091
HM-92	SS-0092	SS-0092
HM-93	SS-0093	SS-0093
HM-94	SS-0094	SS-0094
HM-95	SS-0095	SS-0095
HM-96	SS-0096	SS-0096
HM-97	SS-0097	SS-0097
HM-98	SS-0098	SS-0098
HM-99	SS-0099	SS-0099
HM-100	SS-0100	SS-0100

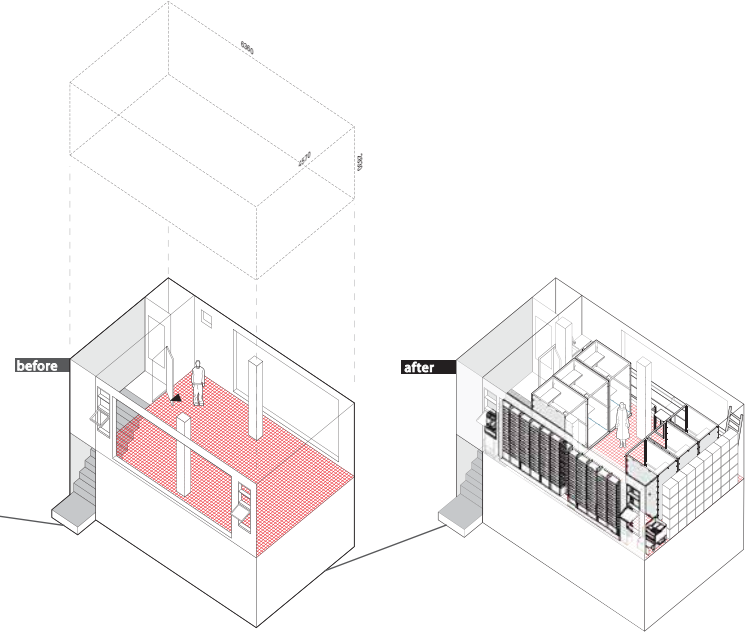
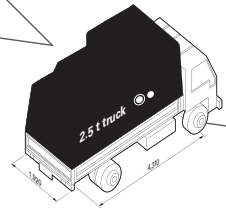

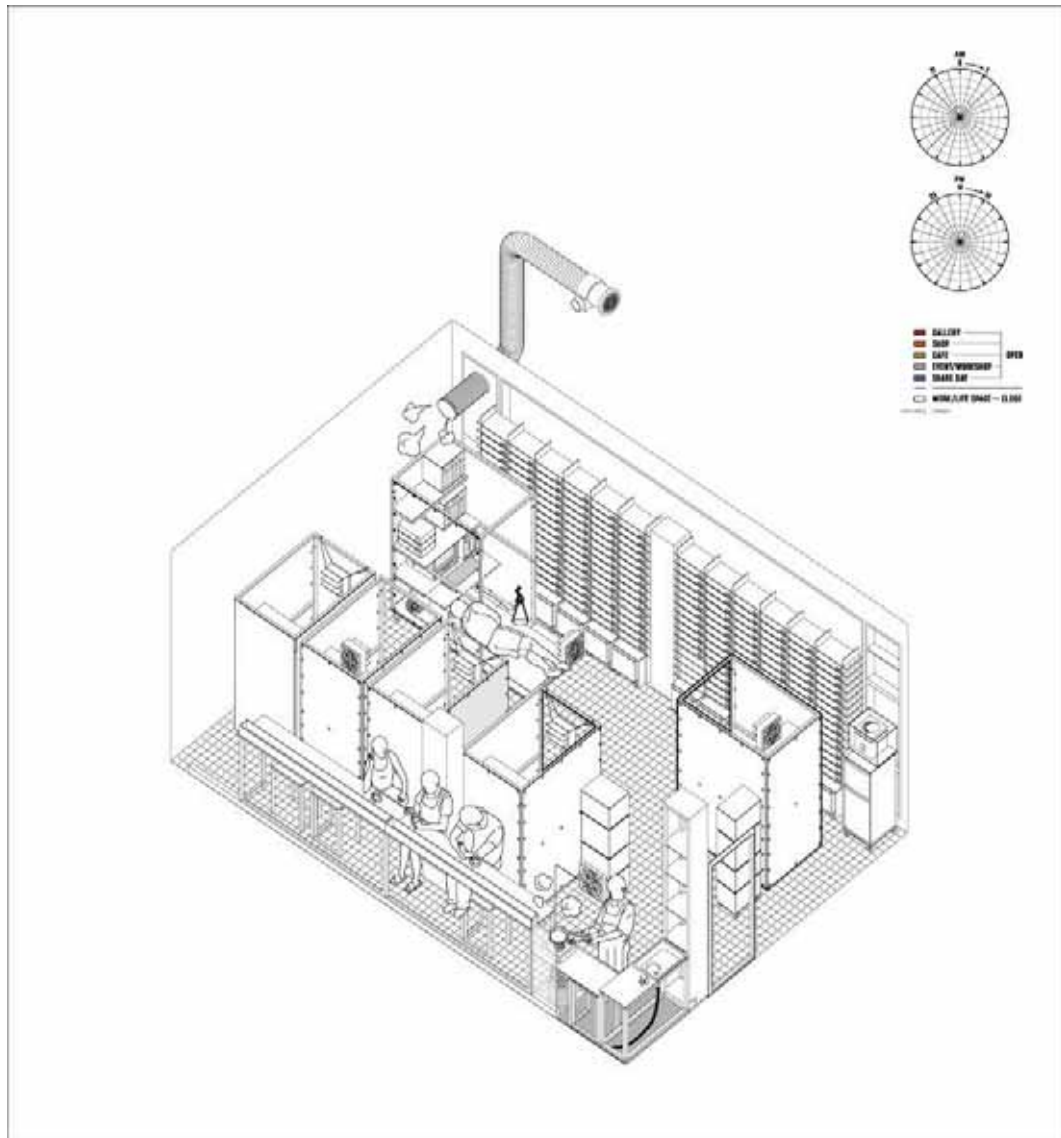
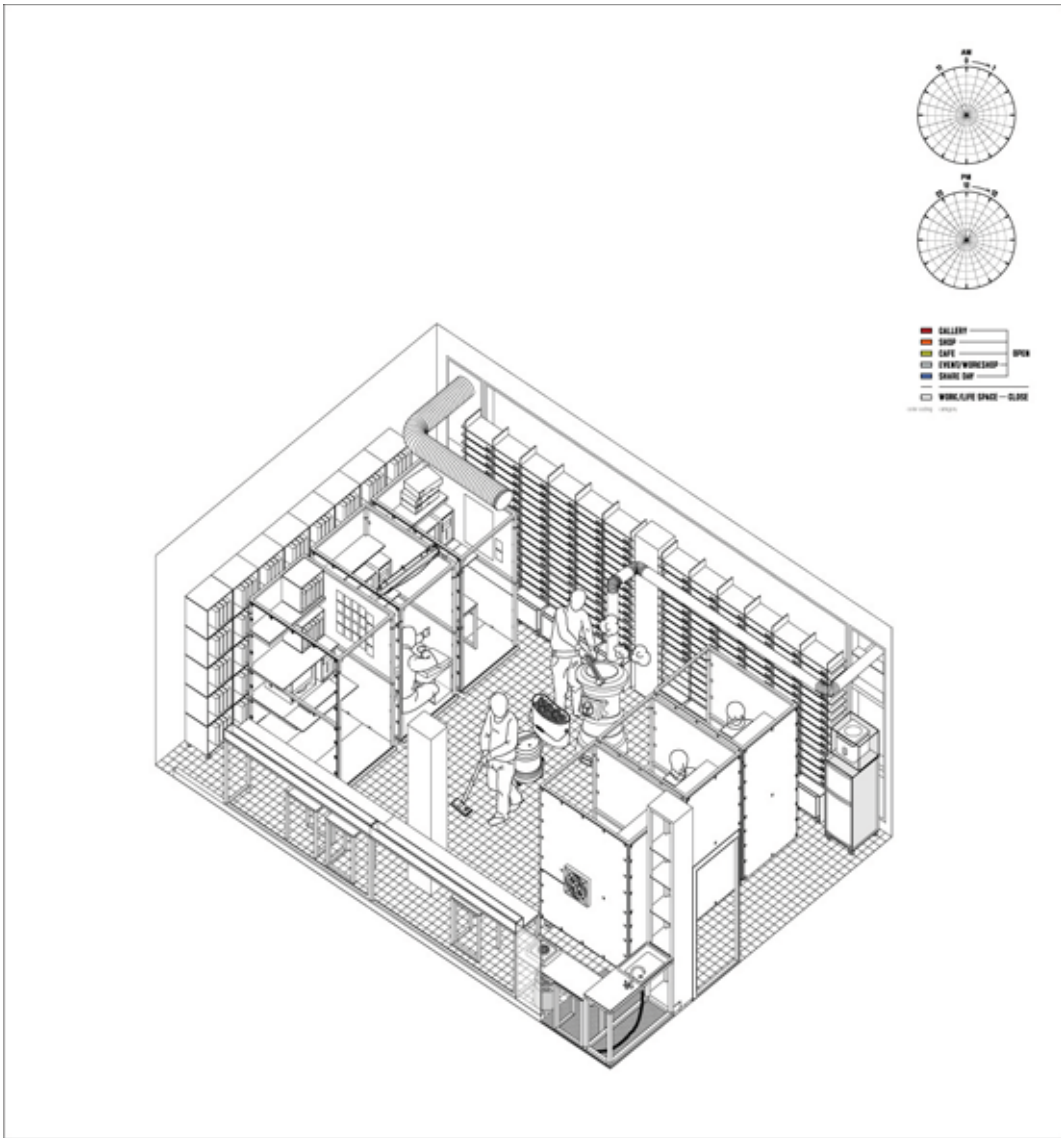

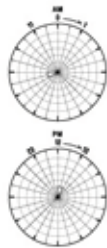

- GALLERY
- SHOP
- CAFE
- EVENT/WORKSHOP
- SHARED DAY
- WORK/LIFE SPACE - CLOSE

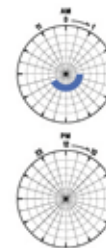
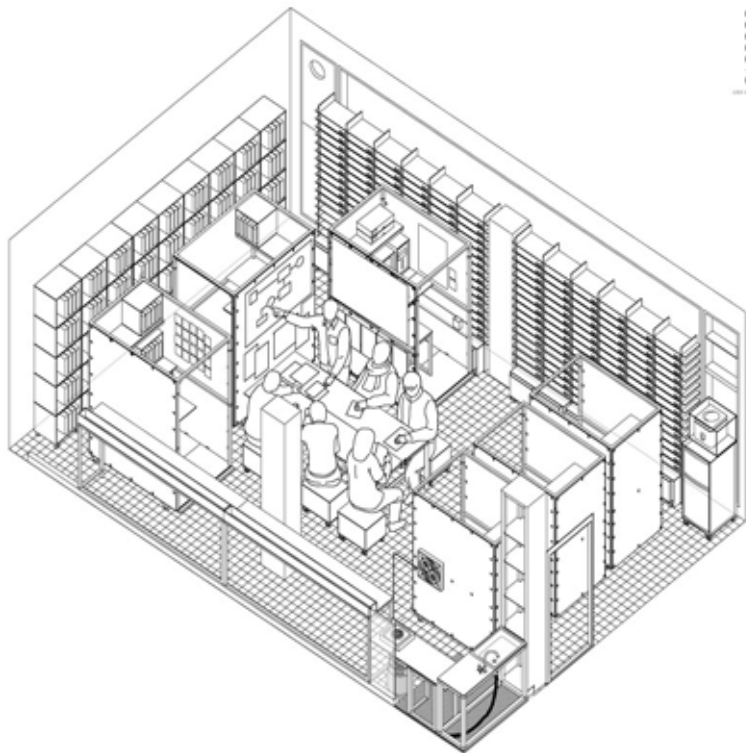

- GALLERY
- SHOP
- CAFE
- EVENT/WORKSHOP
- SHARED DAY
- WORK/LIFE SPACE - CLOSE

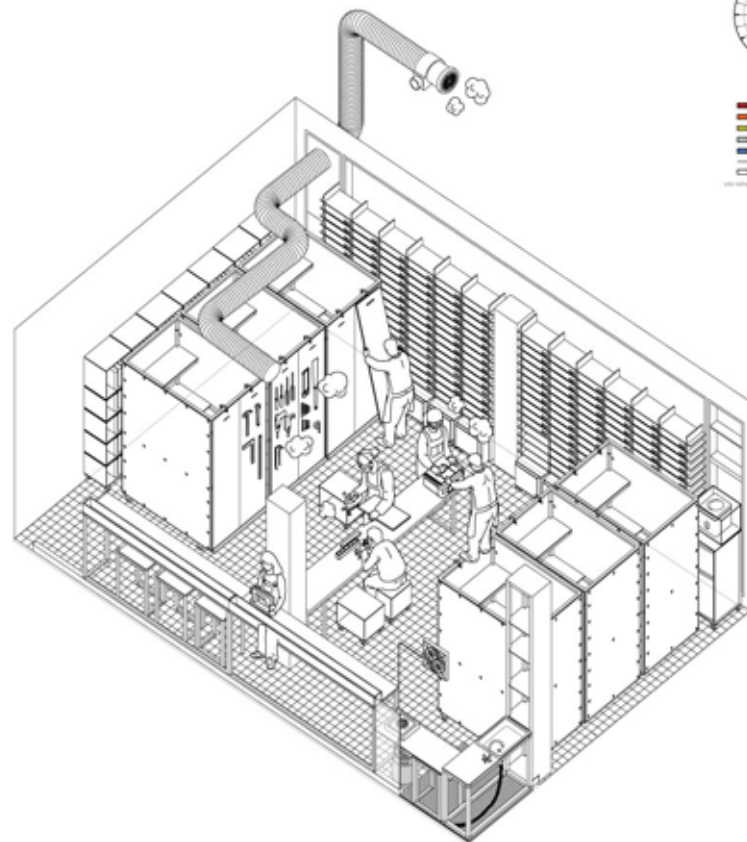

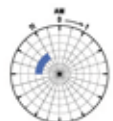

- GALLERY
- SHOP
- CAFE
- OPEN/WORKSHOP
- STAND CAFE
- WORK/LIFE SPACE - CLOSE

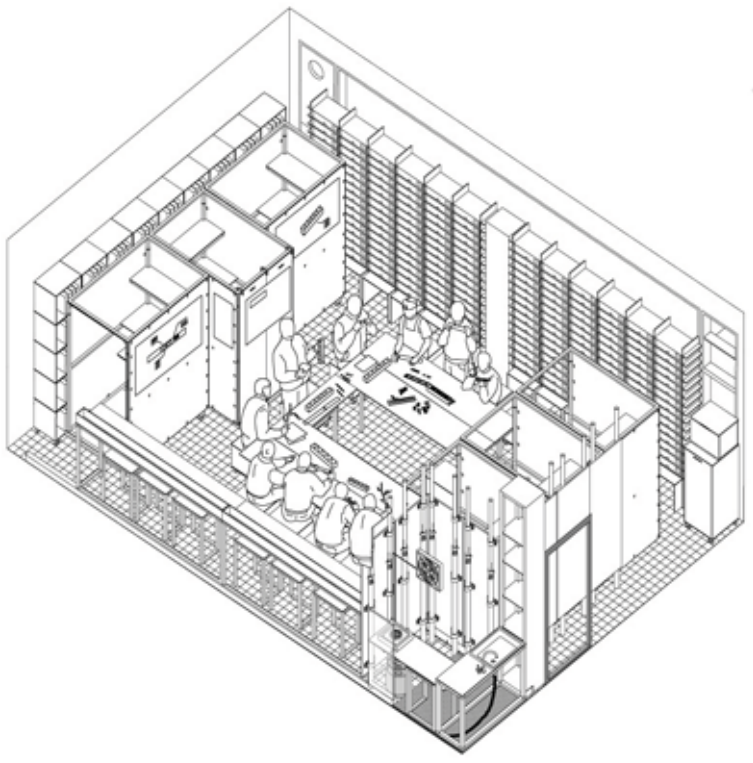

- GALLERY
- SHOP
- CAFE
- OPEN/WORKSHOP
- STAND CAFE
- WORK/LIFE SPACE - CLOSE

